

BRUKS[®]

New Mobile Chipper 806

News & Improvements

806 ST and STC

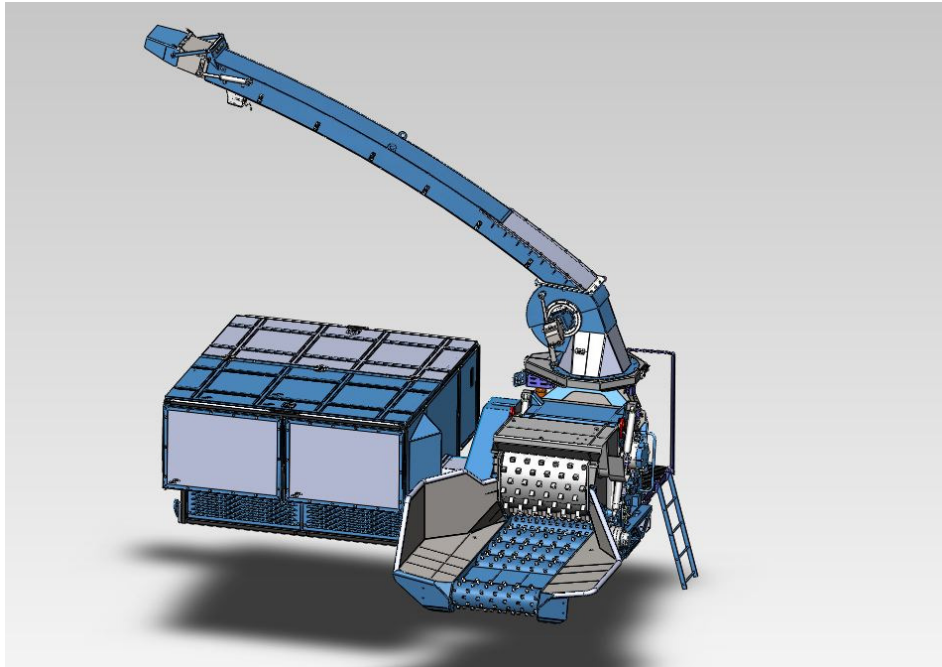

806 ST

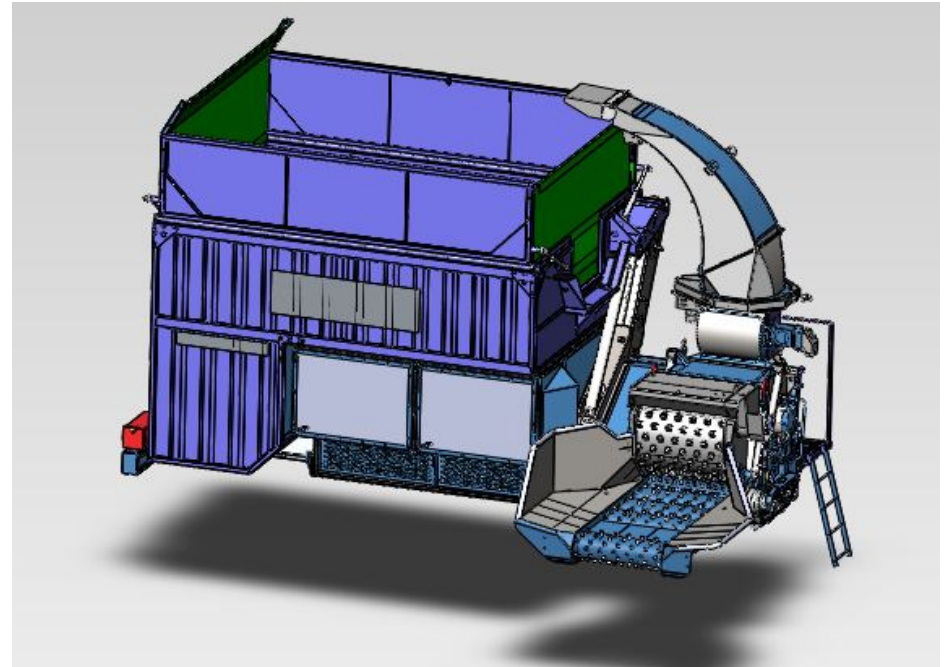

806 STC

Module concept image 806 ST and STC

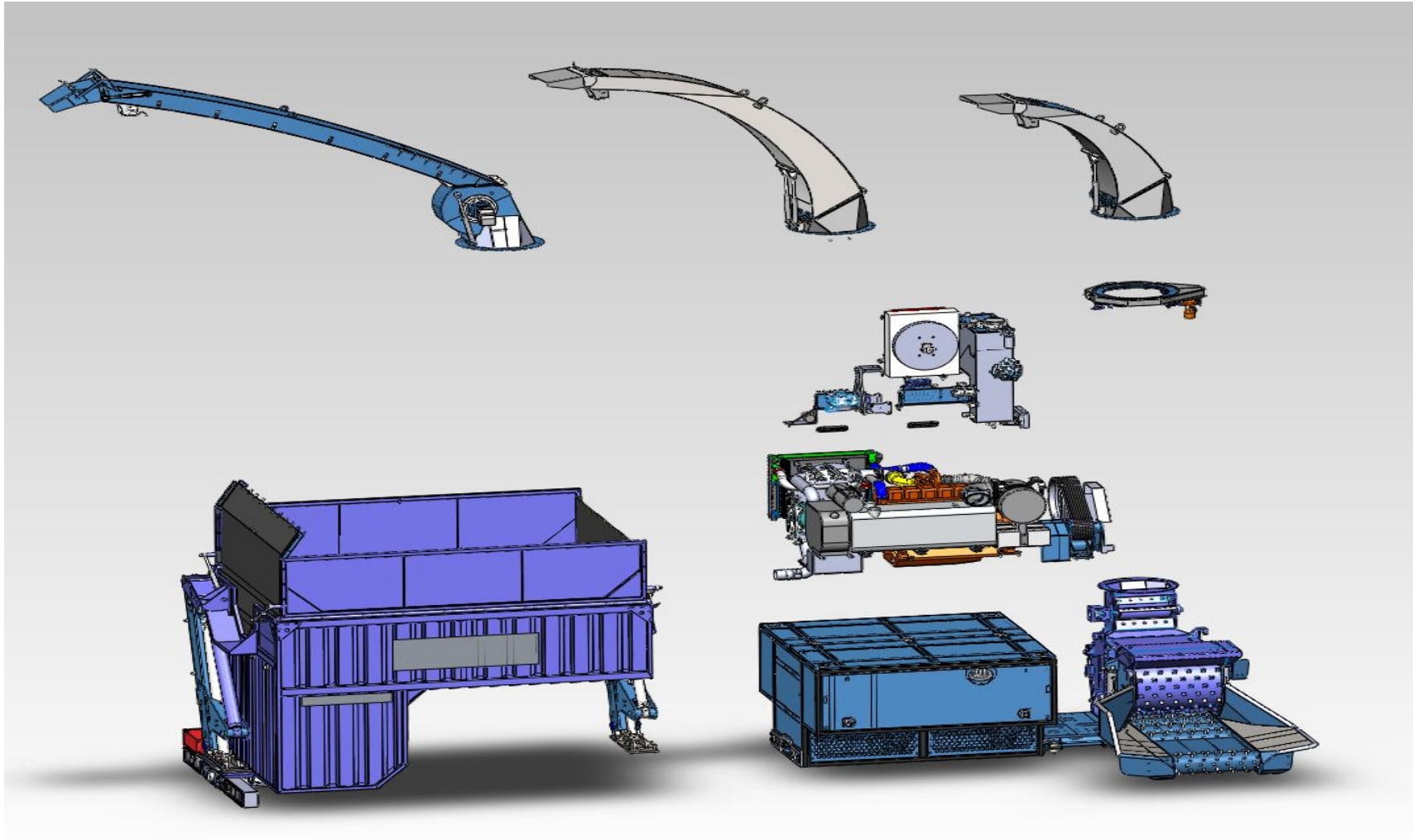

The chipper is built in modules so that it's easier to configure for different customers and different conditions.

New combined drum with Bruks approved chip technique for the best chip quality

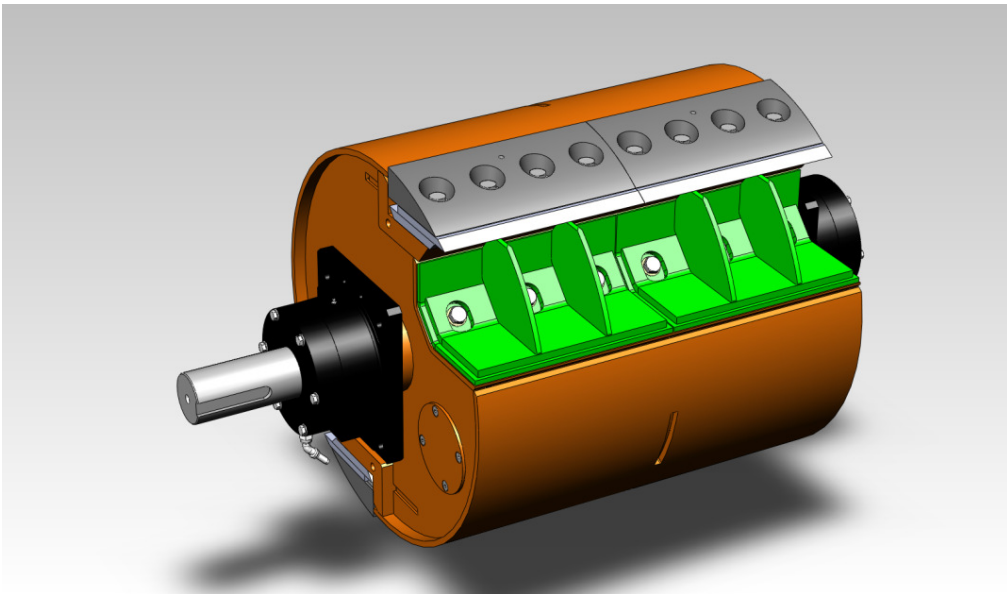
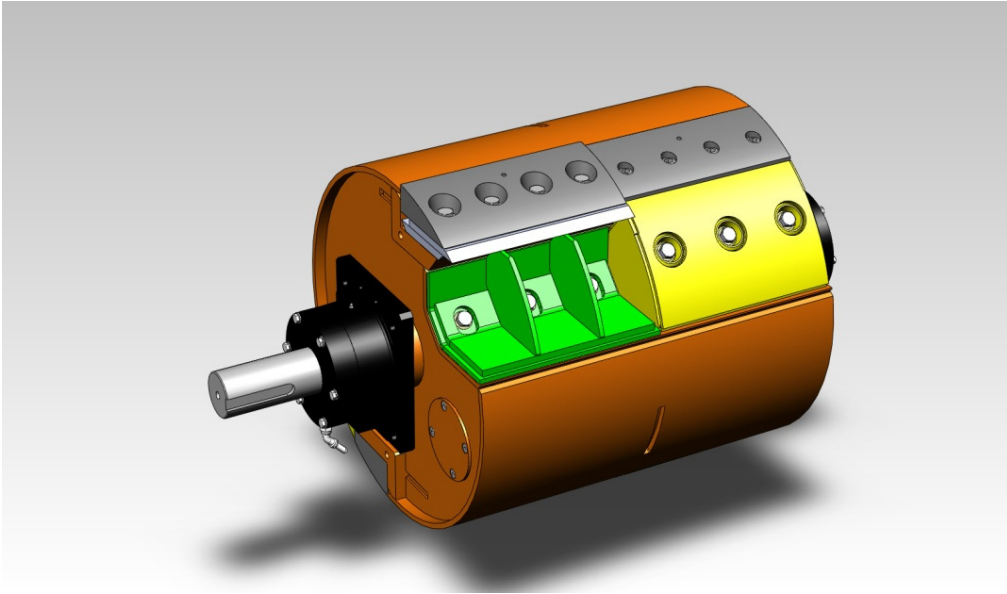

- The new drum makes it possible to use with different knife settings.
- *½ length displaced knives*
- *Full length knives*
- *Adjustable chip length 40 – 45 mm*
- Heating plants demand sometimes longer chips, we make it possible!
- Chip pockets are exchangeable for easy and cheap maintenance.

Other alternative drums



1/2 length displaced knives



Full length knives

New infeed table

- The new design of the infeedtable makes it possible to build it longer and bigger, but still with a lower transportation height!

- 400-500mm longer
- 4-5 roller
- Lower transportation height

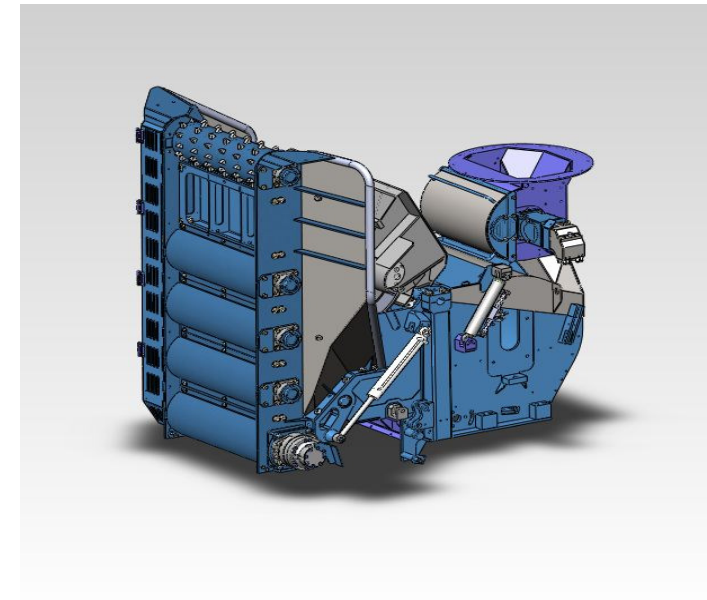
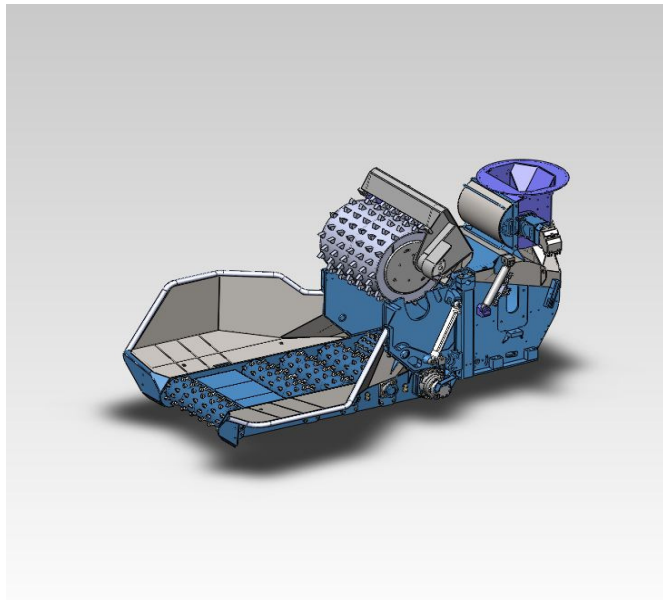
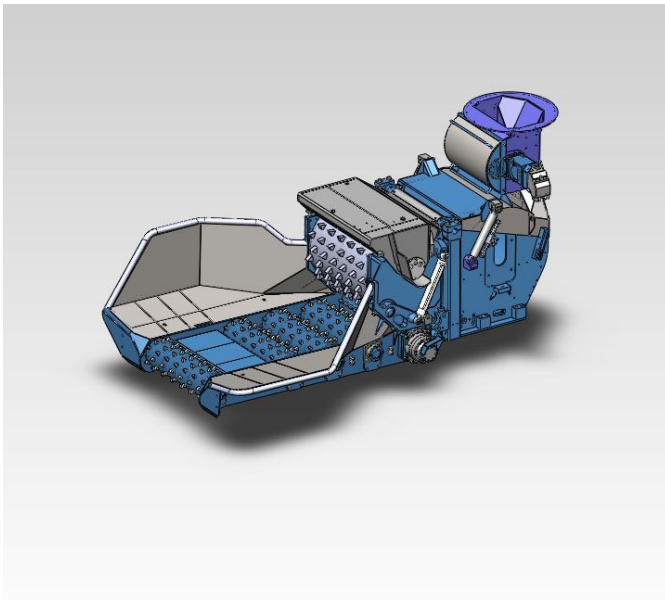

New infeed table in service/cleaning position

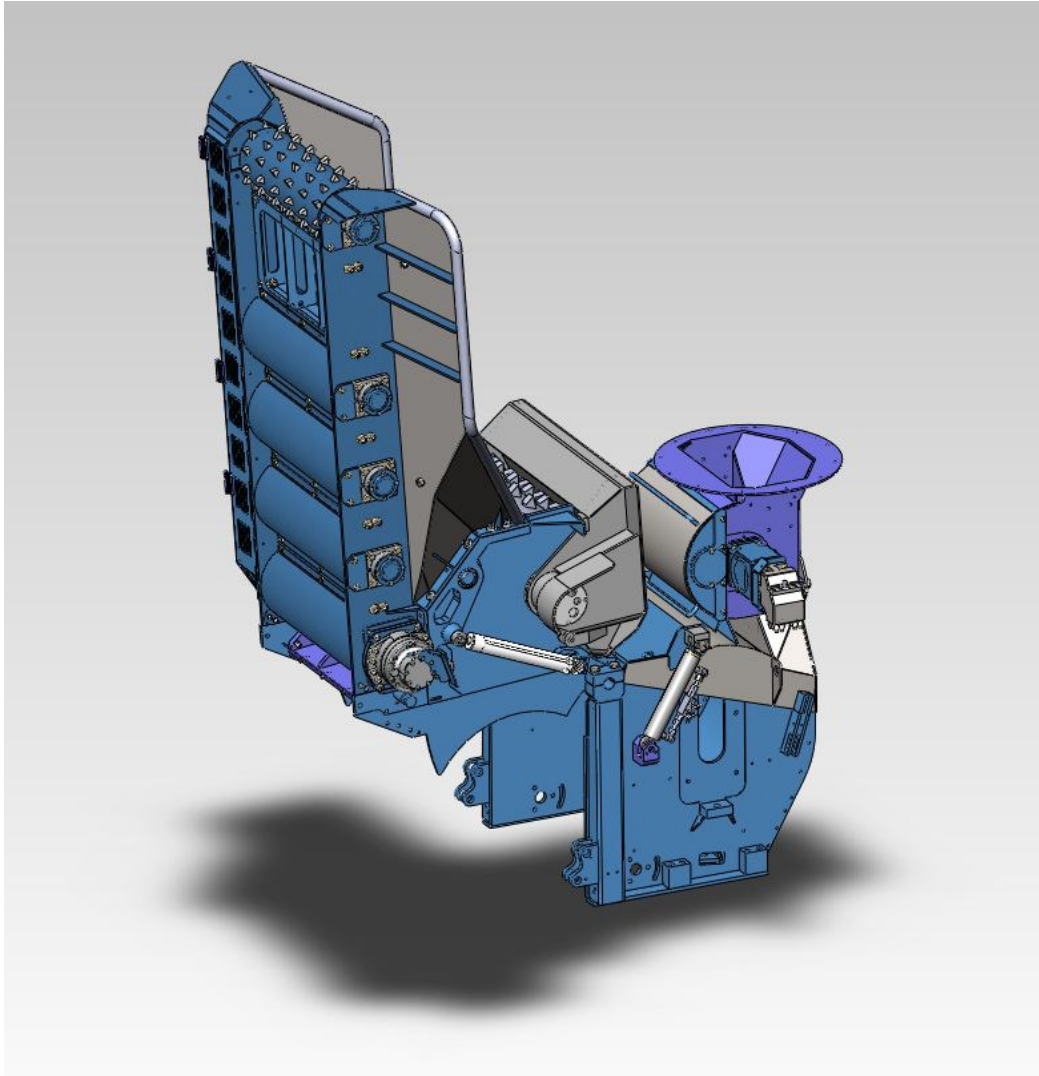

The service position give good access to anvil and drum.

Mounting frame

- Strengthened mounting frame with more mounting points.
- Prepared for slewing ring. No additional frame is necessary.
- Lower construction height when mounting slewing ring.
- Redesigned and strengthened mounting brackets.

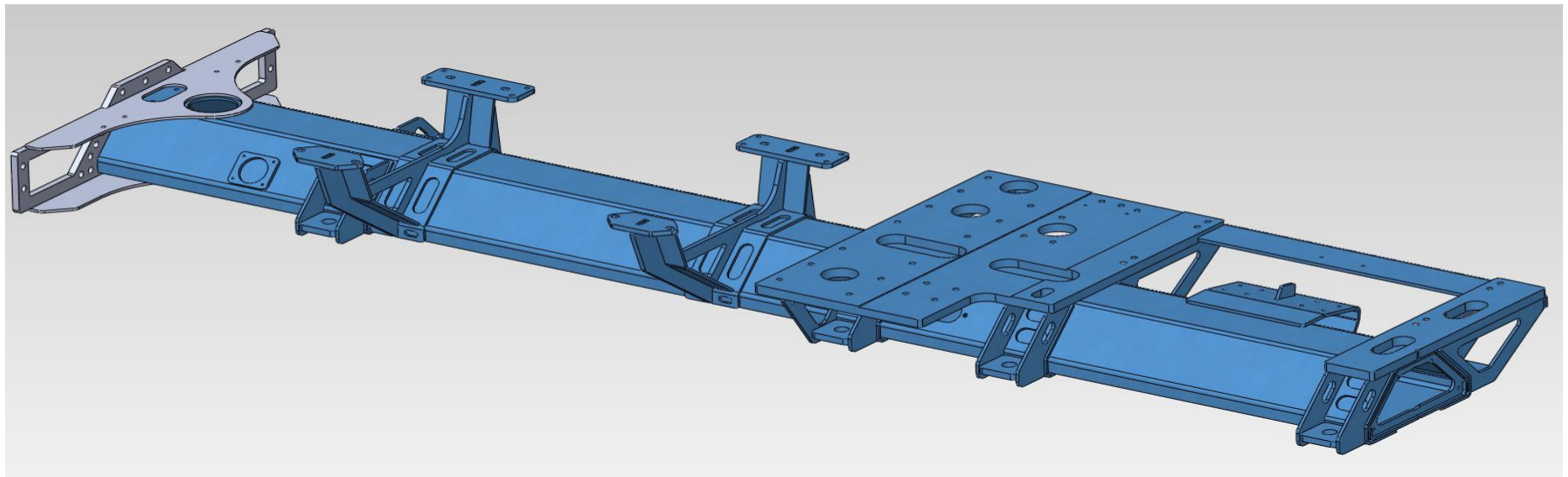

Chip bin



- Redesigned and strengthen container
- New type of elevation with net cover in front and rear end
- Lower transportation height due to lower crane gaps
- Extra high dumping yokes available as option

New, stronger and more fuel efficient diesel engine

New Scania engine DC13 077A

- With AdBlue and catalytic emission controls to fulfill new demands EU Step IIIB.
- Completely new engine installation

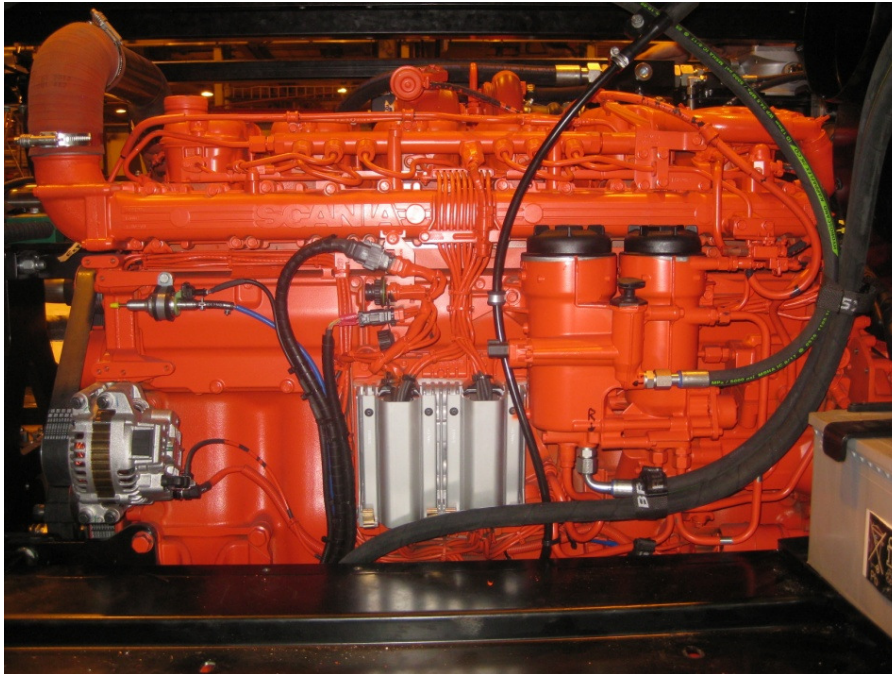
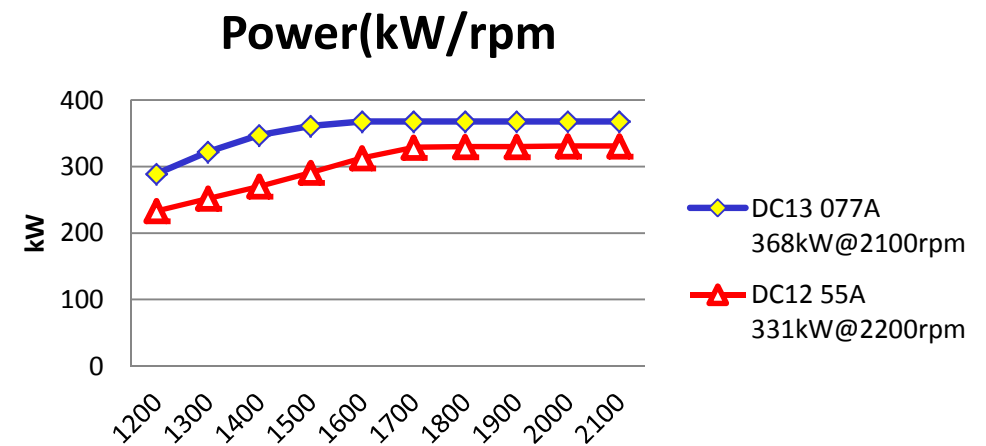
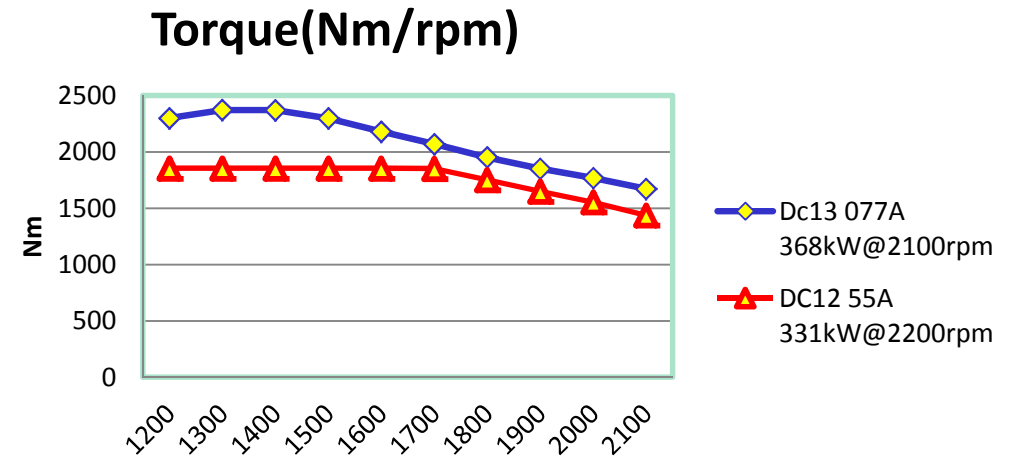

Diagram New DC 13 verses DC12



Hydraulic system



- Pressure classified ORFS couplings
- Separated, bigger hydraulic cooler
- Bigger hydraulic tank and filter
- Automatic temperature control of fan for engine and hydraulic cooling
- Service friendly hydraulic system
- A bigger hydraulic pump to be able to run a separate crane, as option on ST units

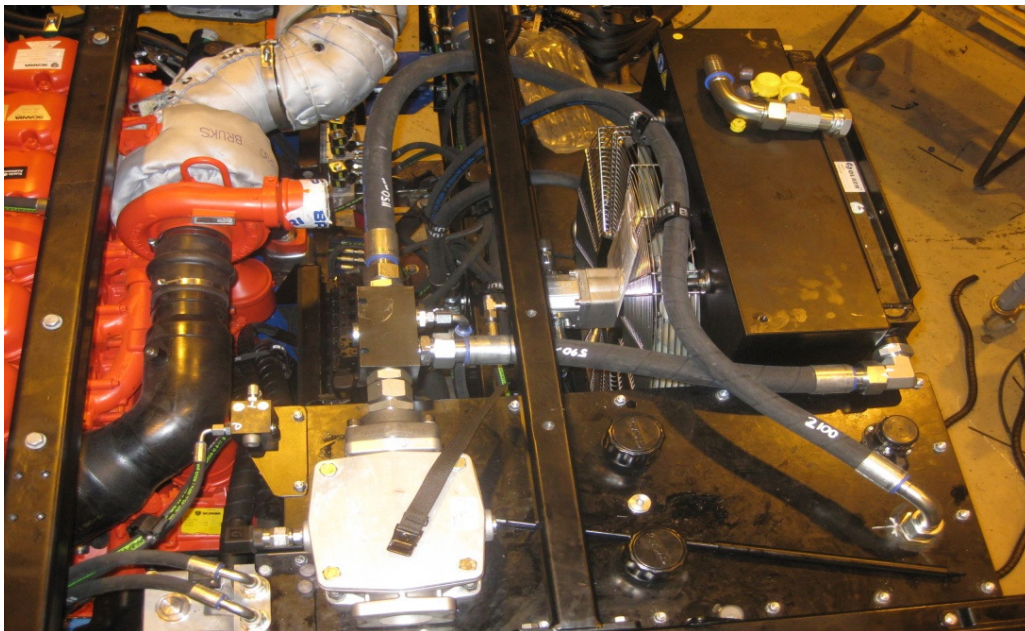

Chip-accelerator drive with improved technology



- Accelerator pump on separate power takeoff
- Hydrostatic driven
- Keeps rpm, even with lower diesel engine rpm
- Easy adjustment of rpm, for different material and needs
- Readable speed
- Lower speed will give lower noise, dust, fuel consumption and wear in chip tube

Electric- & steering system

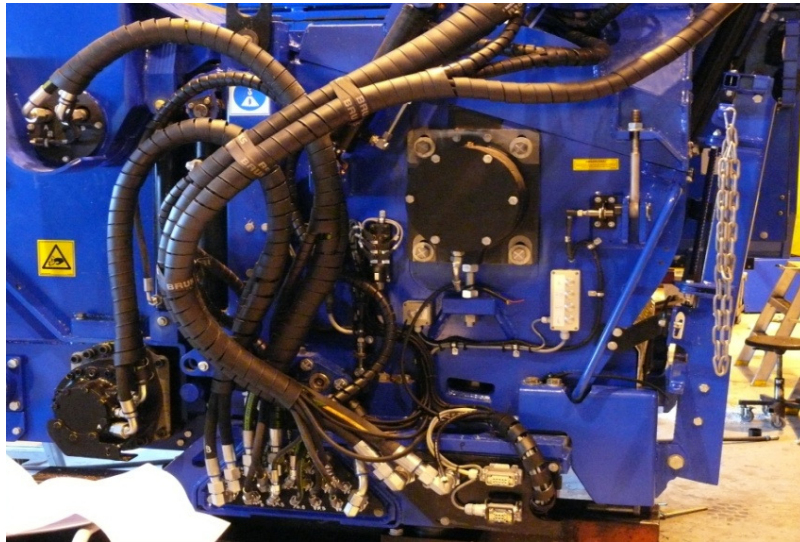
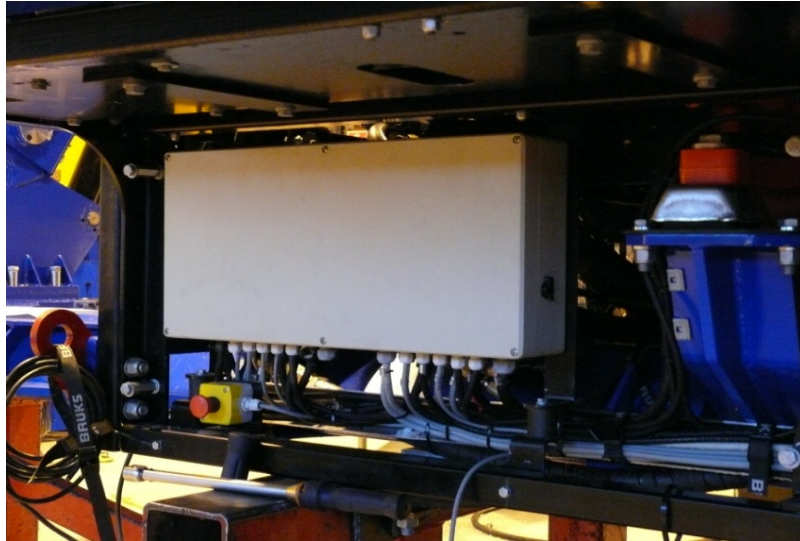

- New improved infeed control.
- Improved and more user friendly menu's.
- New type of sensors.
- Engine diagnostics.
- Production follow up.

New color



- New dark blue standard color RAL 5005
- Frame in black color
- Durable powder painting
- Possible to choose from a variety of colors to a low extra cost

[BRUKS.COM](https://bruks.com)